

- Rozlišení změn detailů:**
- ① 1. etapa - ZÚ křižovatka II/160 - odbočka Horní Dvořiště (2790m)
  - ② 2. etapa - odbočka Horní Dvořiště - odbočka Jenín (1302m)
  - ③ 3. etapa - odbočka Jenín - KÚ (635m)

Dopravně inženýrské opatření  
**Modernizace silnice II/163 (křiž. s II/160 - Rybník)**

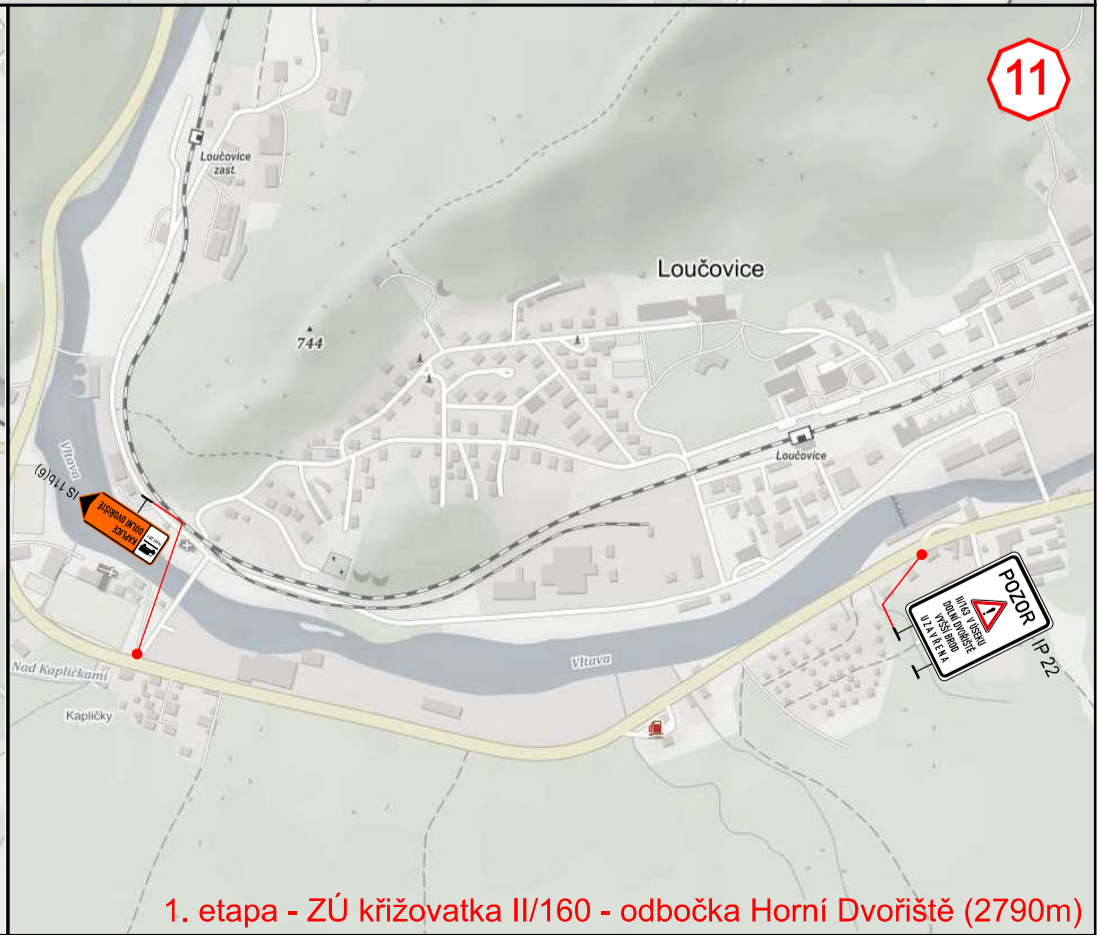

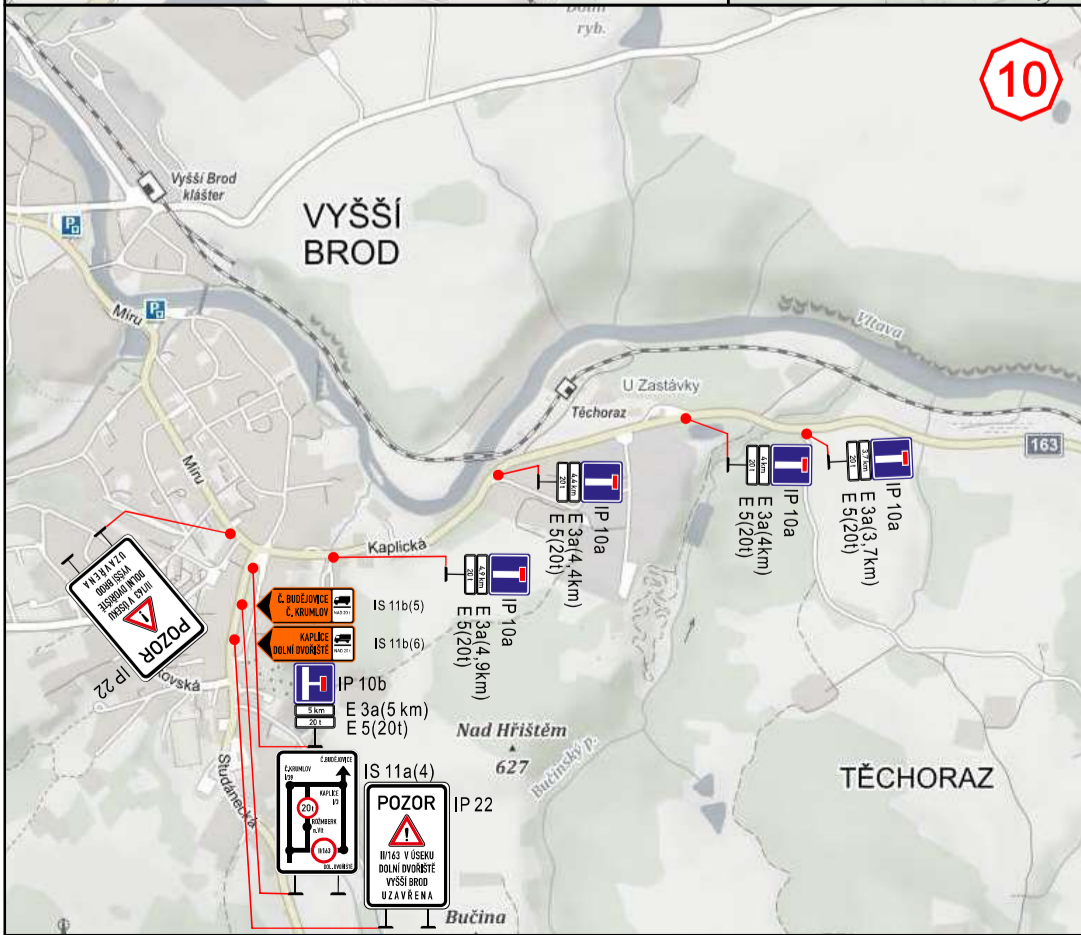
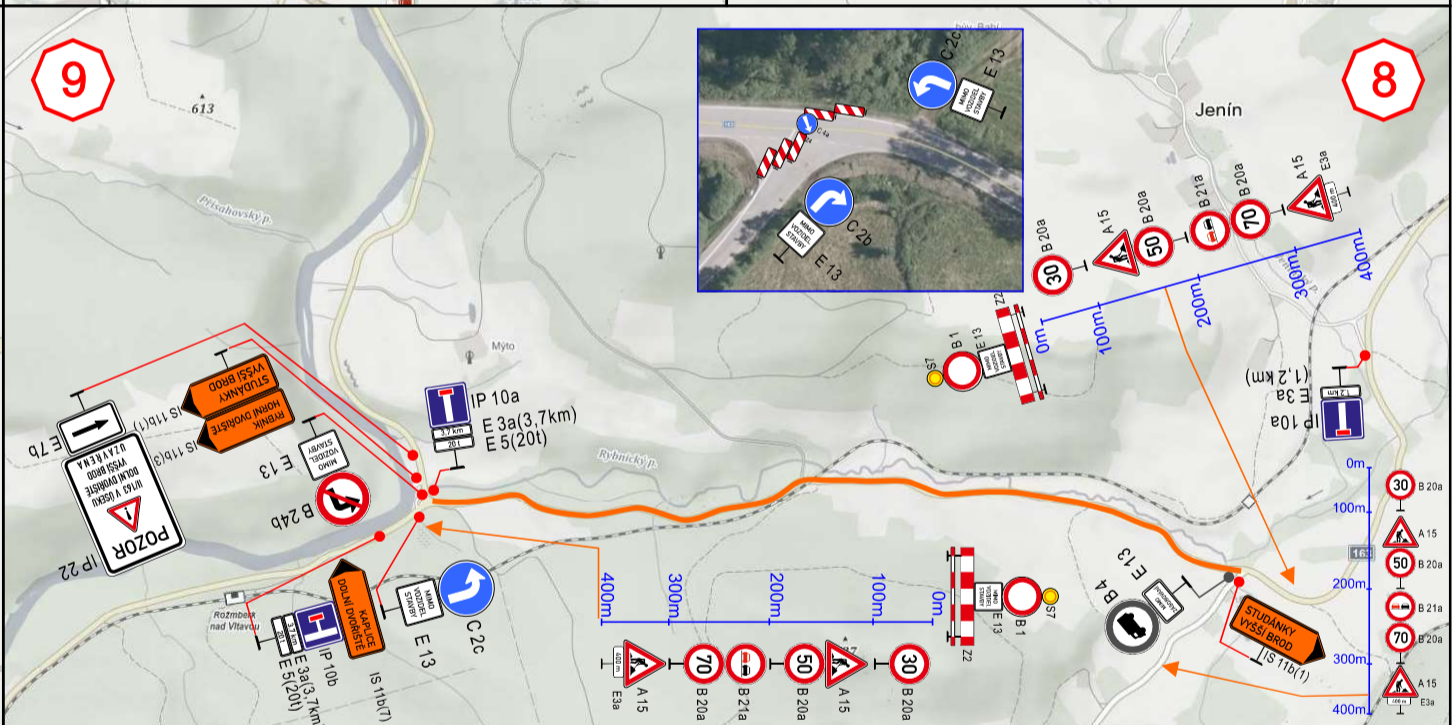
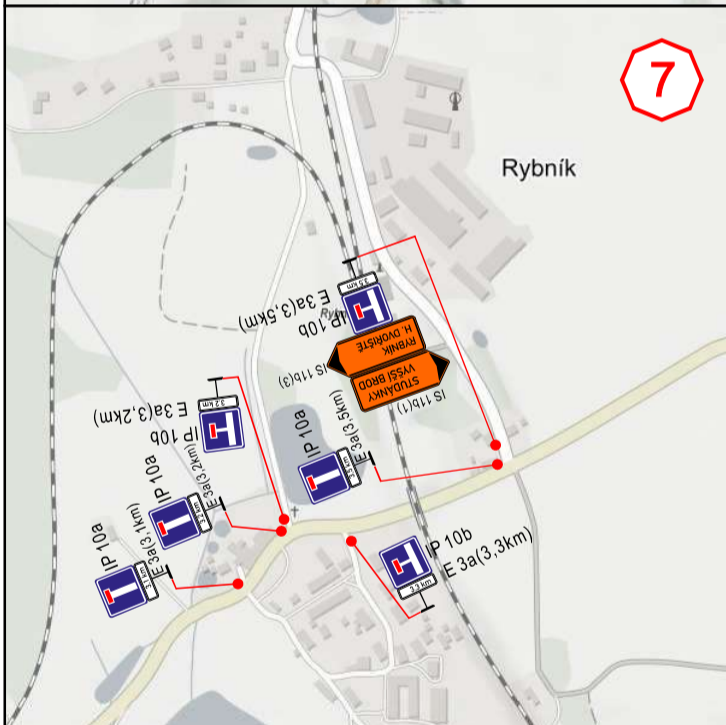
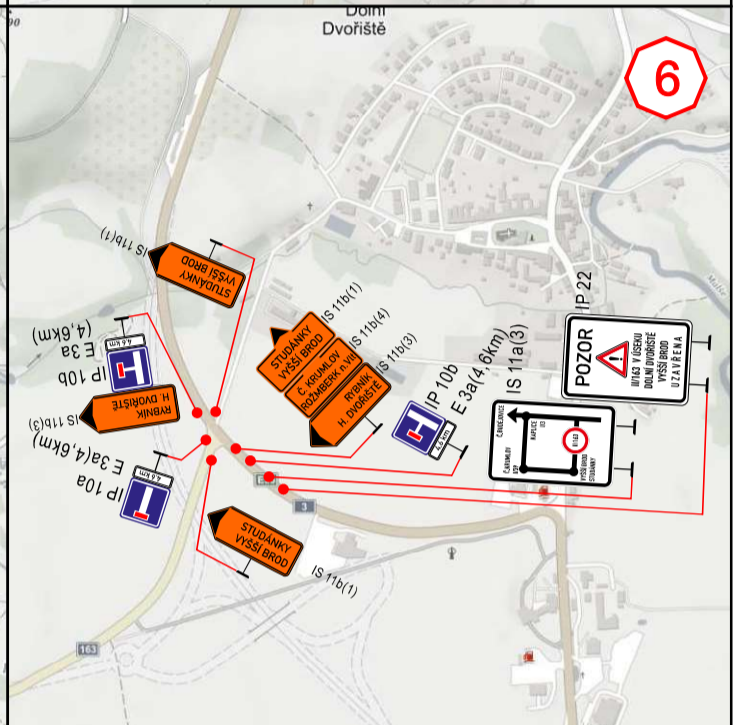
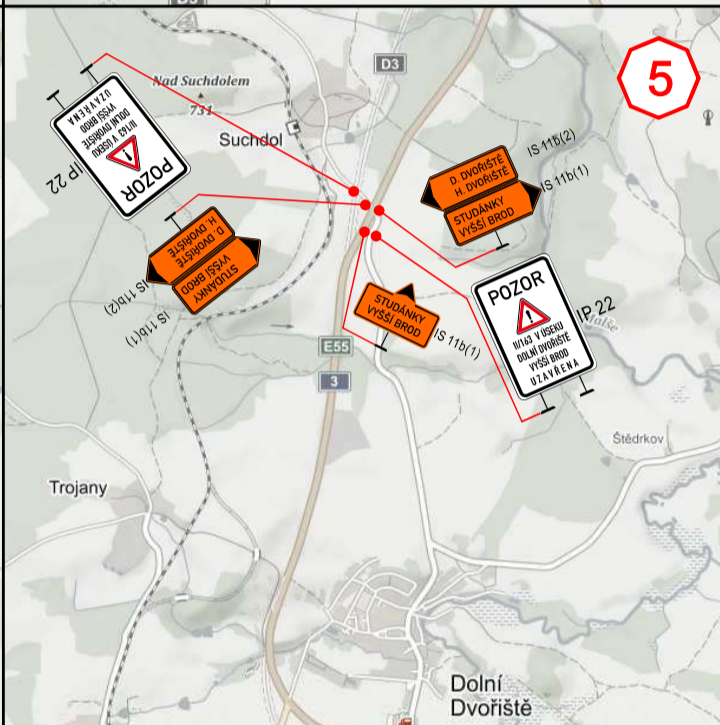
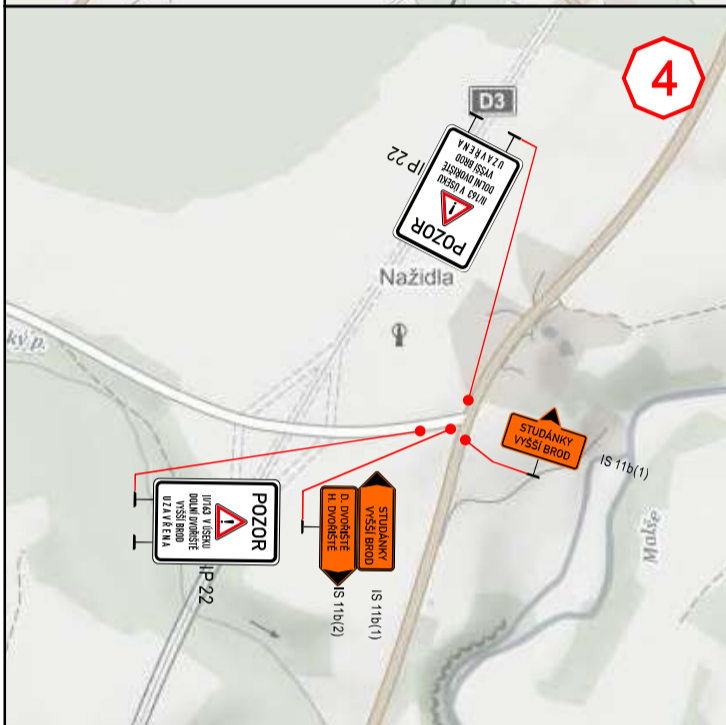
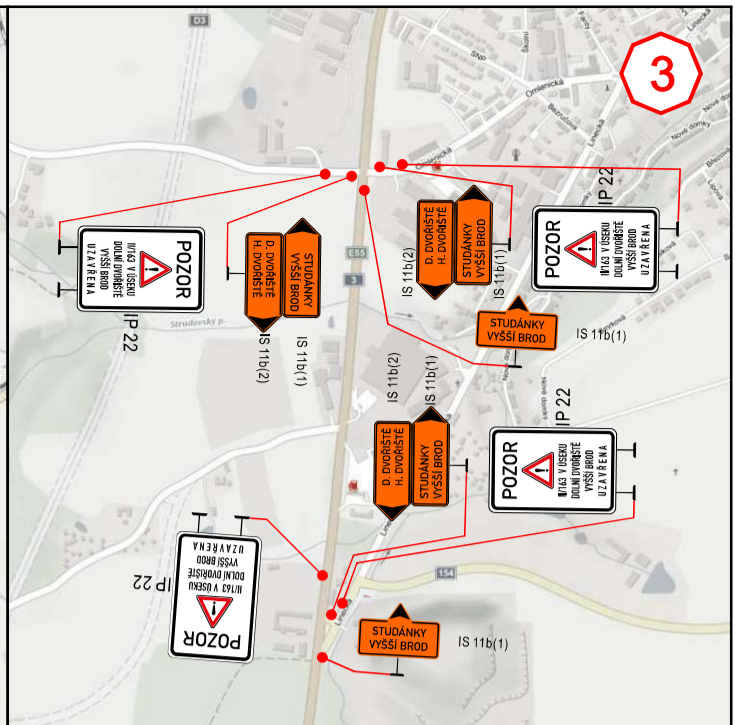
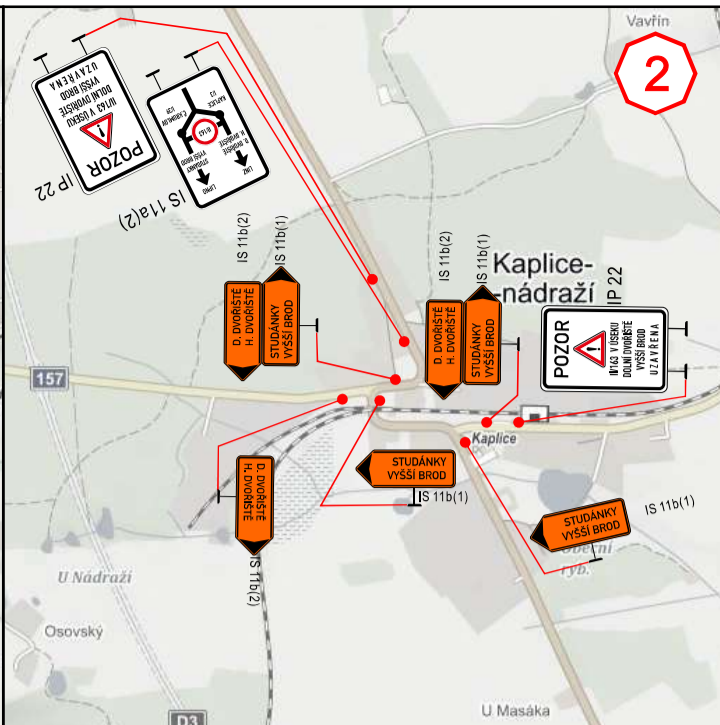
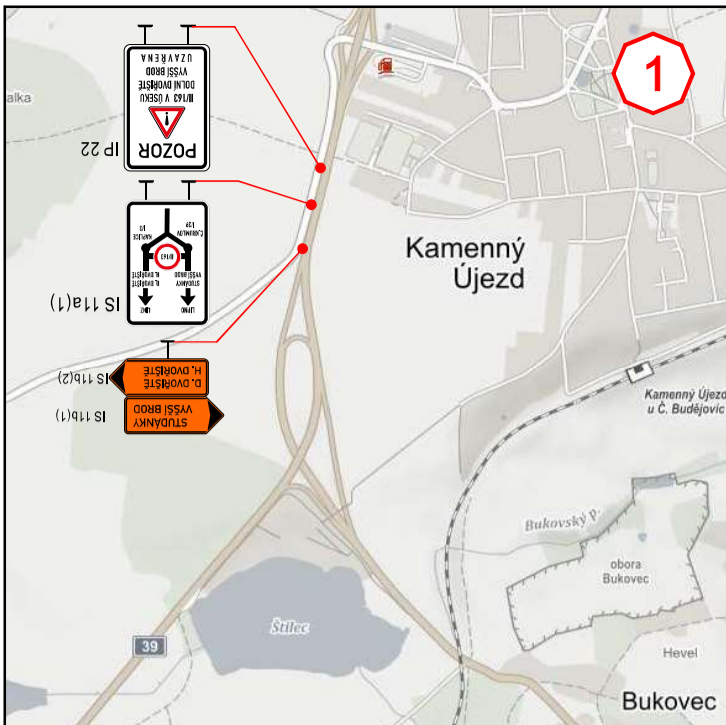

Zadavatel: <b>SWIETELSKÝ - M.Pavlík - 725 966 130</b>	
Zpracoval: Michal Jelínek	Dne: 07/2022
Email: jelinek@signistav.cz	Poznámka: verze 1. form.A3 SITUACE
Telefon: 702 281 494	



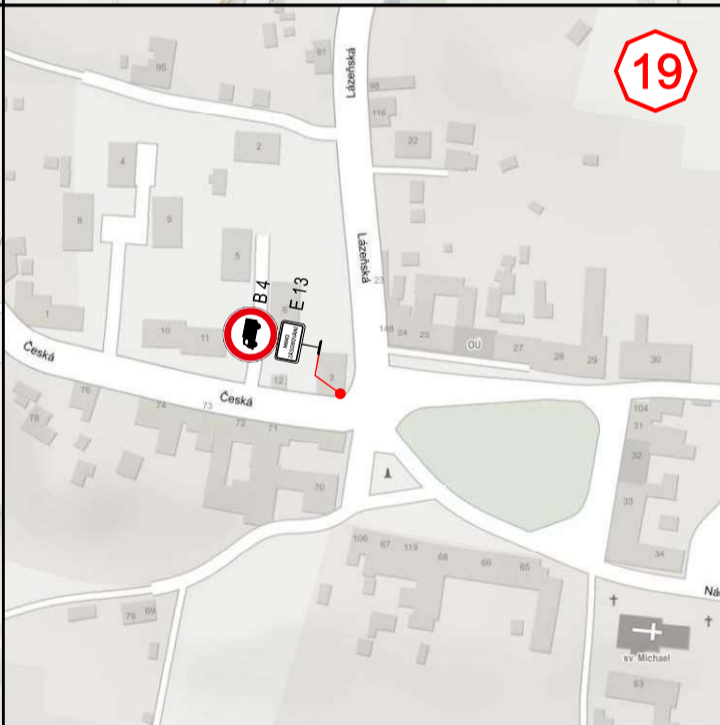
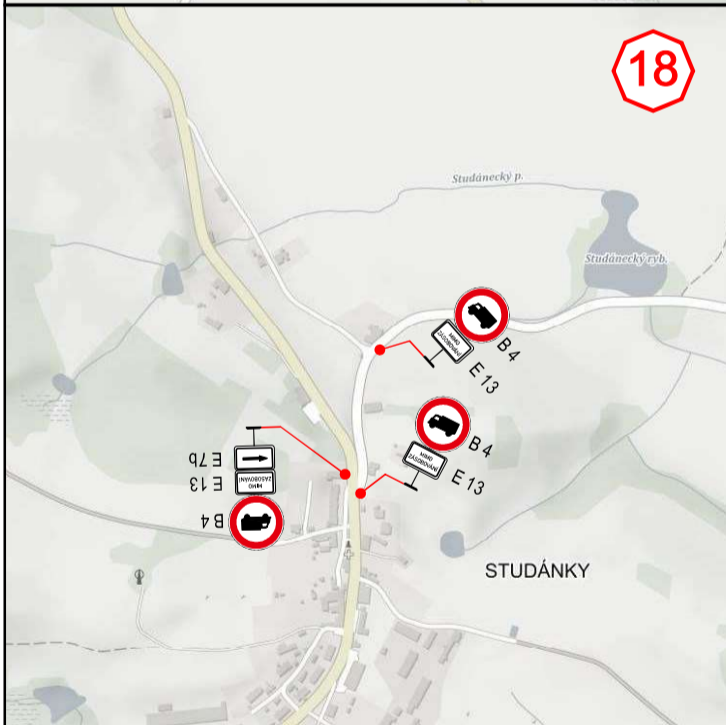
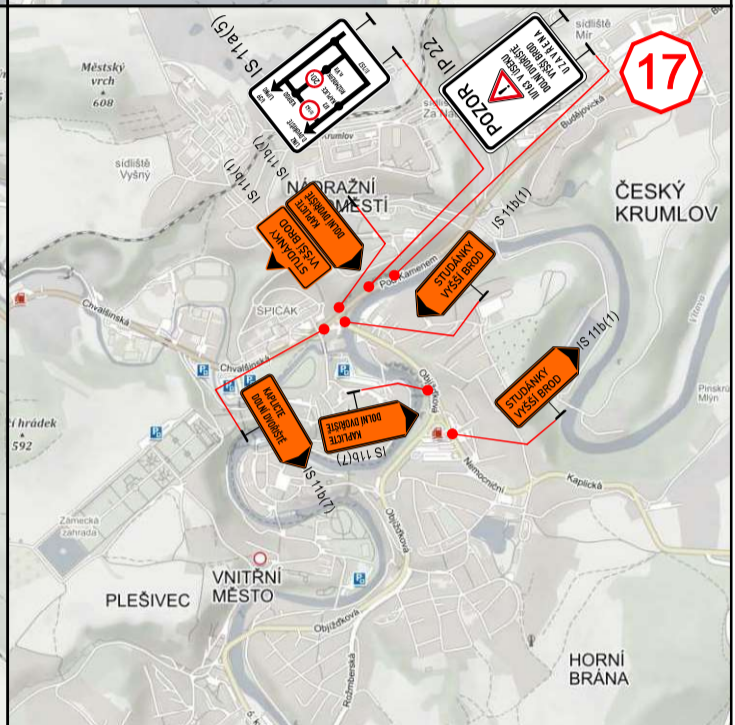
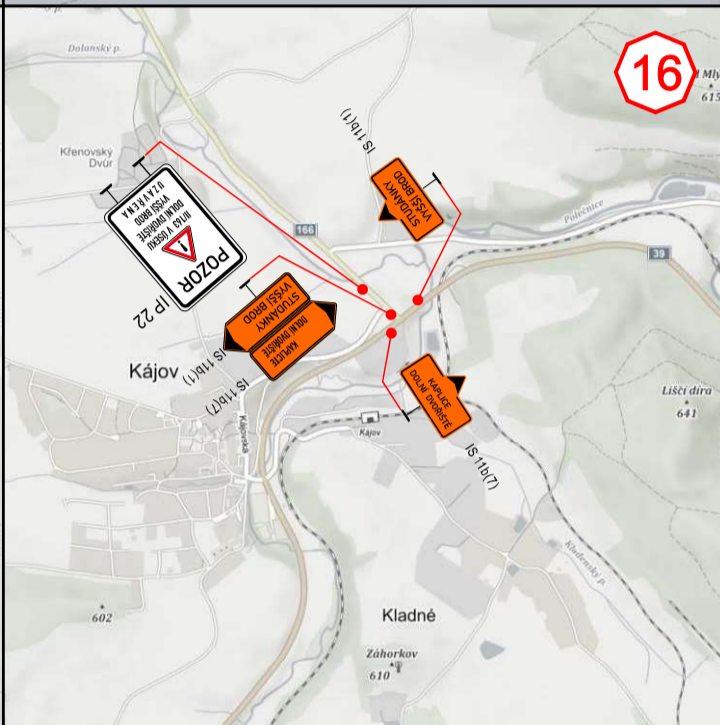
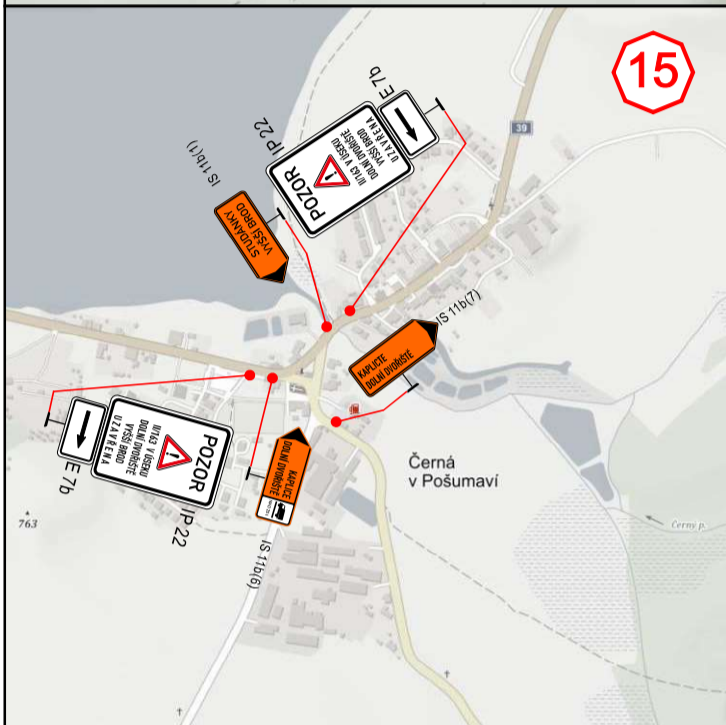
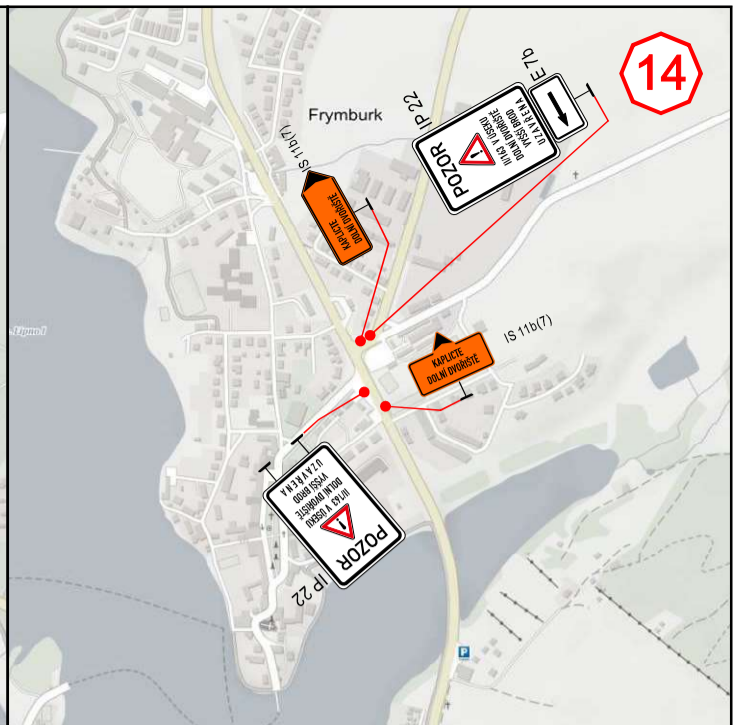
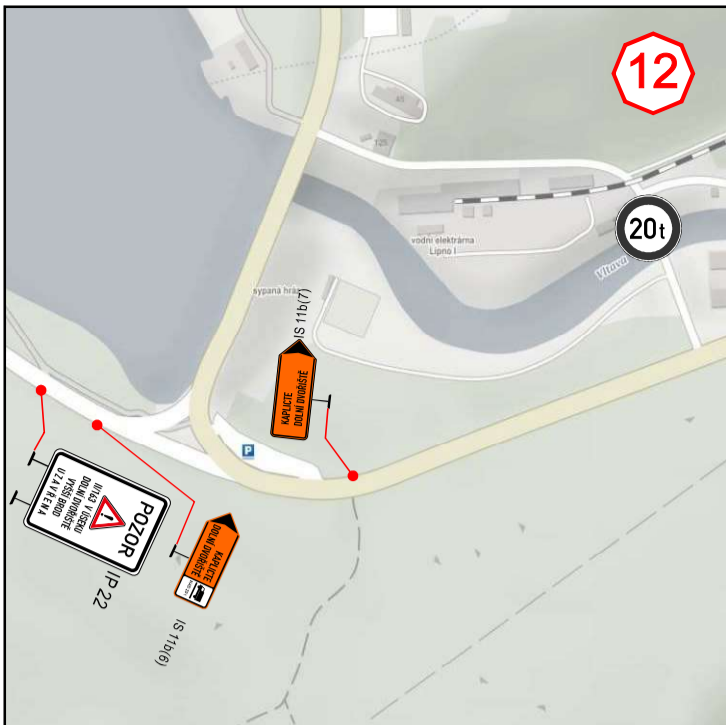

1. etapa - ZÚ křižovatka II/160 - odbočka Horní Dvořiště (2790m)



-  **STUDÁNKY VYŠŠÍ BROD** IS 11b(1)
-  **D. DVOŘIŠTĚ H. DVOŘIŠTĚ** IS 11b(2)
-  **RYBNÍK HORNÍ DVOŘIŠTĚ** IS 11b(3)
-  **Č. KRUMLOV ROŽMBERK n.Vlt** IS 11b(4)
-  **Č. BUDĚJOVICE Č. KRUMLOV** NAD 20t IS 11b(5)
-  **KAPLICE DOLNÍ DVOŘIŠTĚ** NAD 20t IS 11b(6)
-  **KAPLICE DOLNÍ DVOŘIŠTĚ** IS 11b(7)
-  **HORNÍ DVOŘIŠTĚ** IS 11b(8)

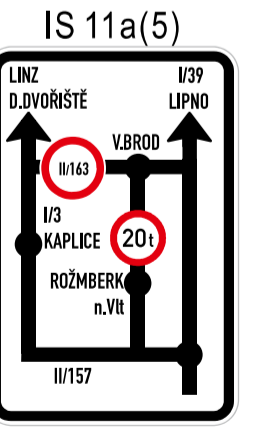
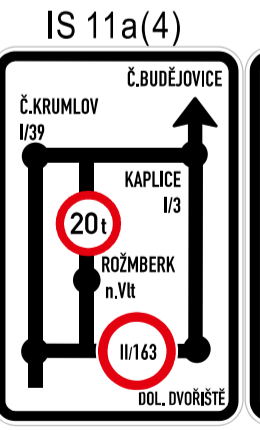
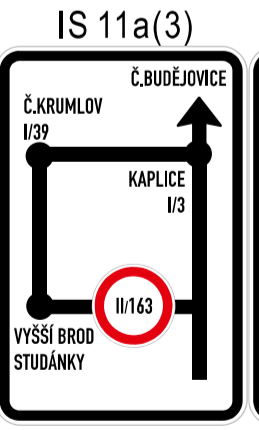
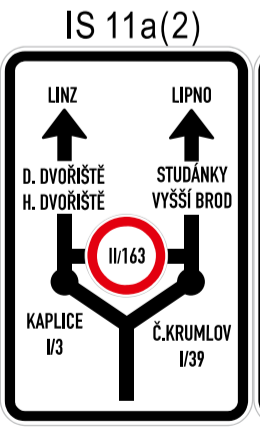
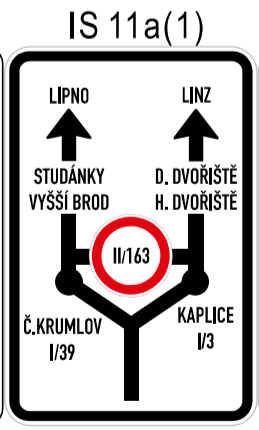



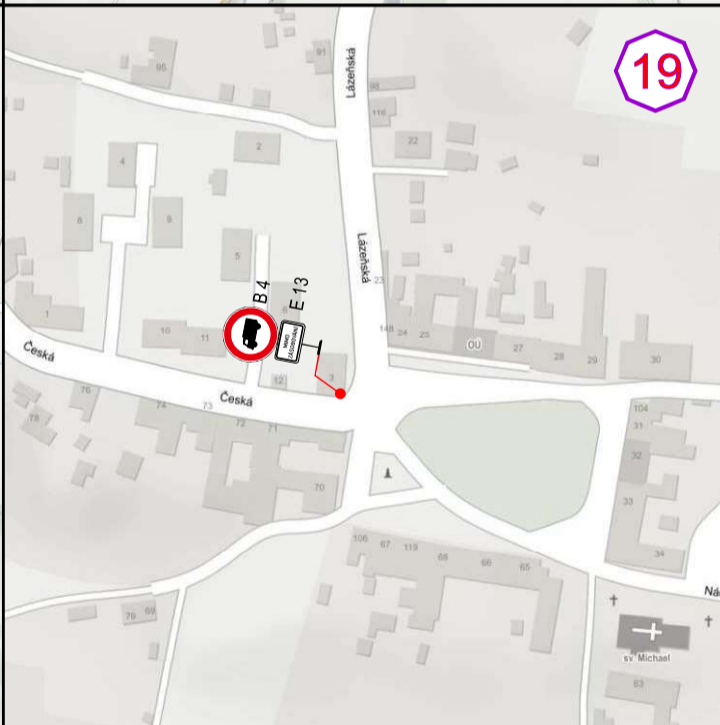
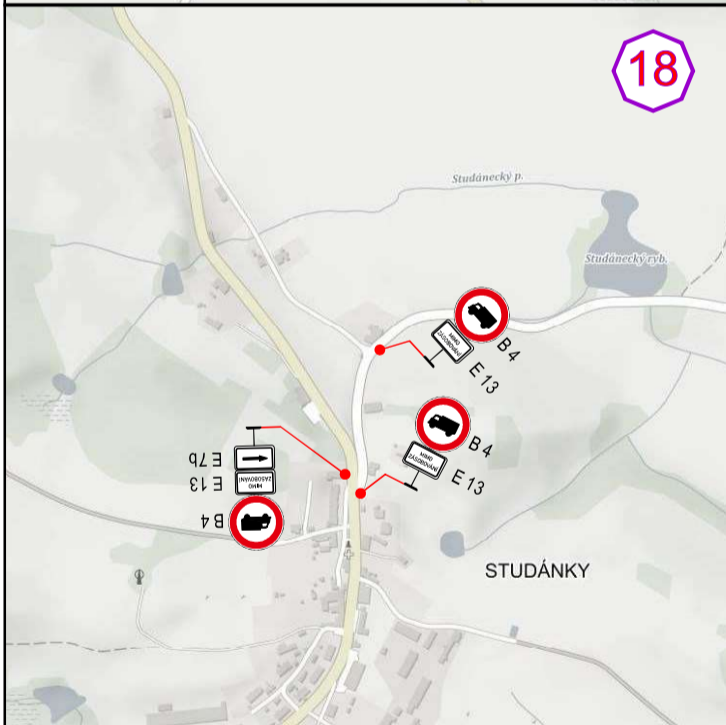
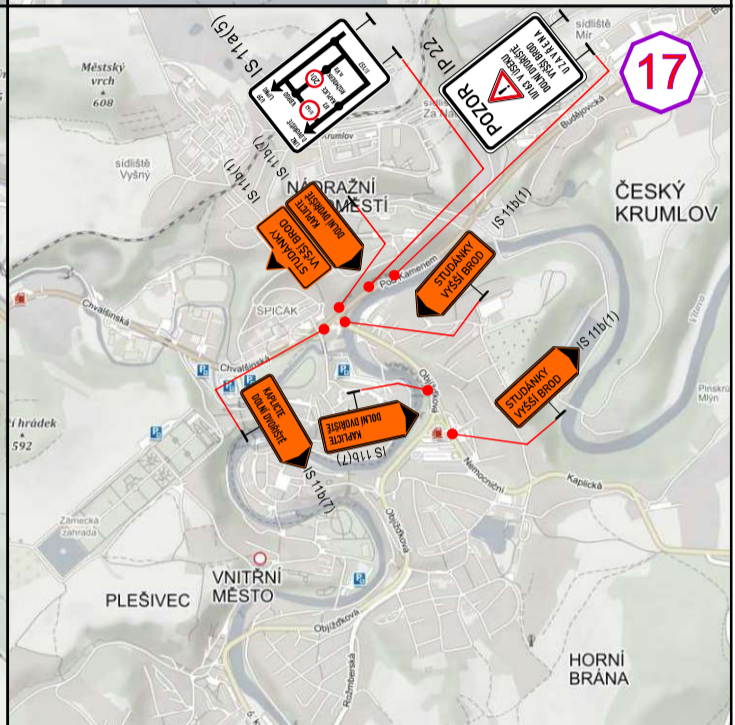
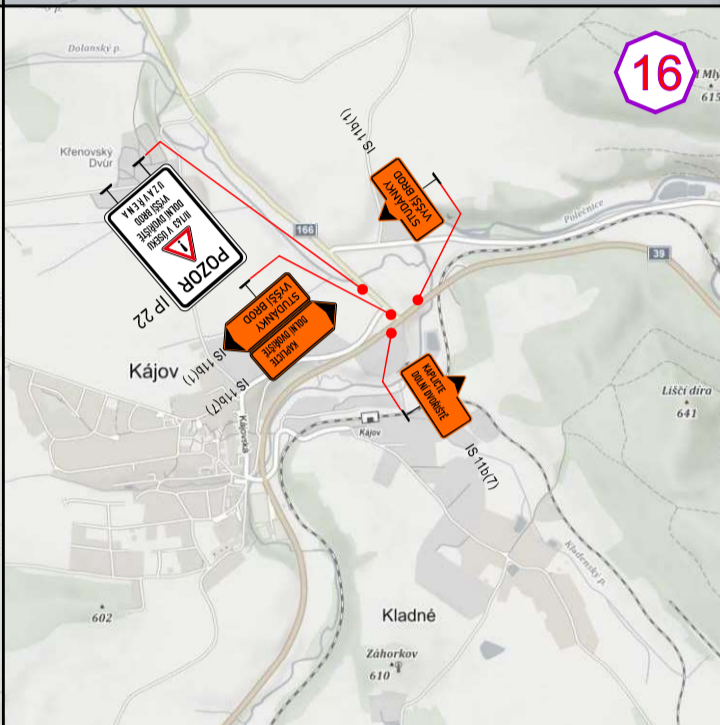
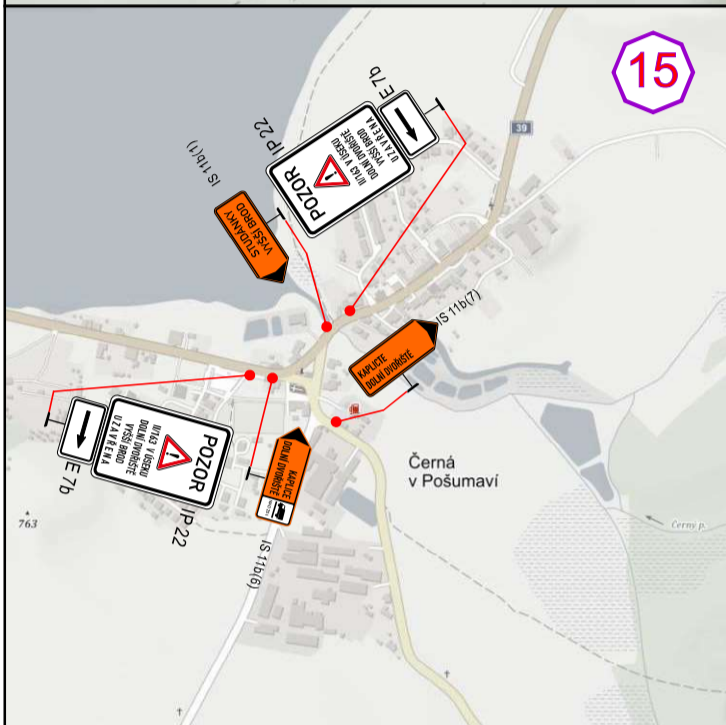
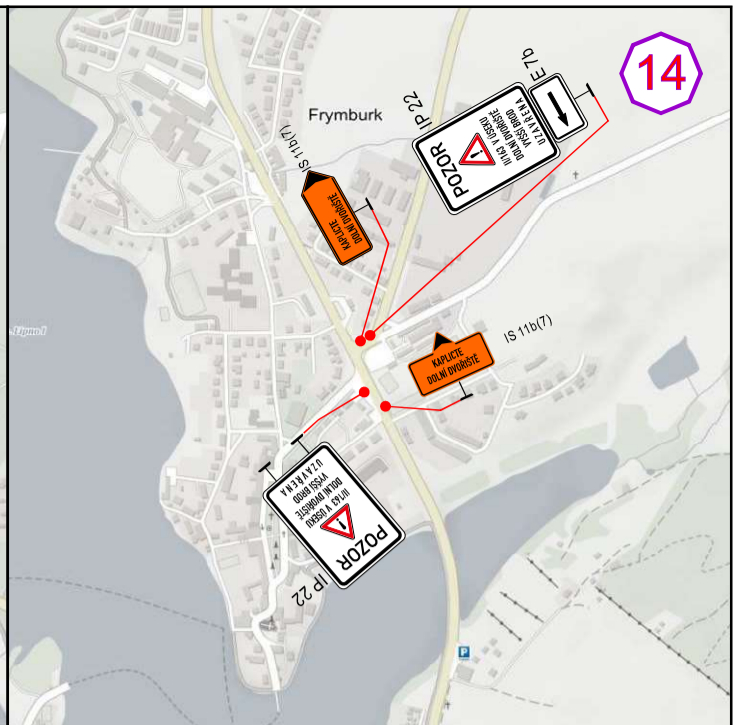
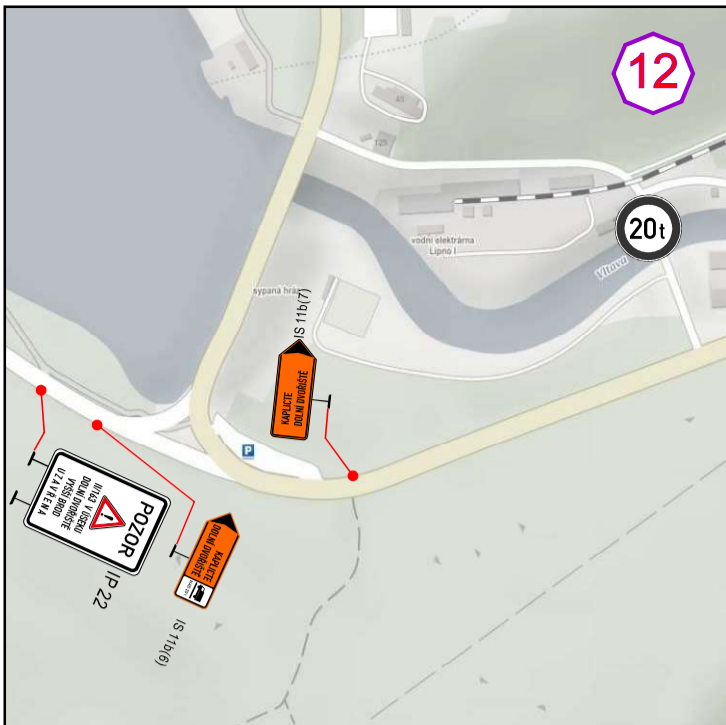

- STUDÁNKY  
HORNÍ DVOŘIŠTĚ IS 11b(1B)
- DOLNÍ DVOŘIŠTĚ  
JENÍN IS 11b(2B)
- RYBNÍK  
JENÍN IS 11b(3B)
- Č. KRUMLOV  
ROŽMBERK n.Vlt IS 11b(4)
- Č. BUDĚJOVICE  
Č. KRUMLOV NAD 20t IS 11b(5)
- KAPLICE  
DOLNÍ DVOŘIŠTĚ NAD 20t IS 11b(6)
- KAPLICE  
DOLNÍ DVOŘIŠTĚ IS 11b(7)
- HORNÍ DVOŘIŠTĚ IS 11b(8)

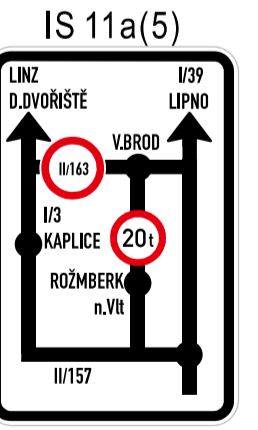
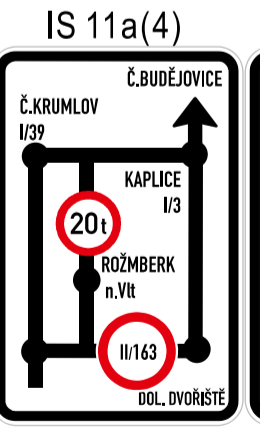
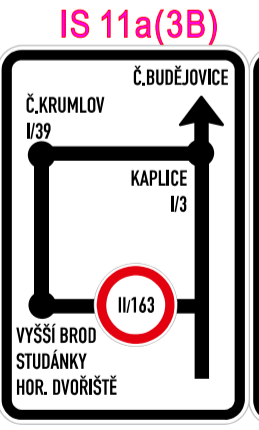
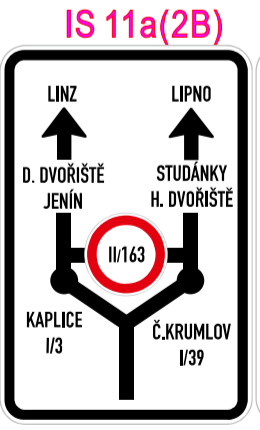
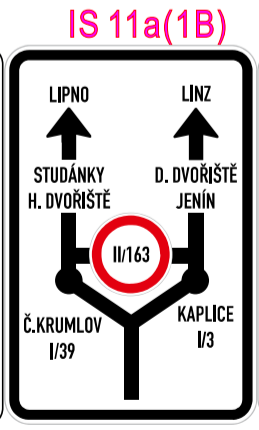

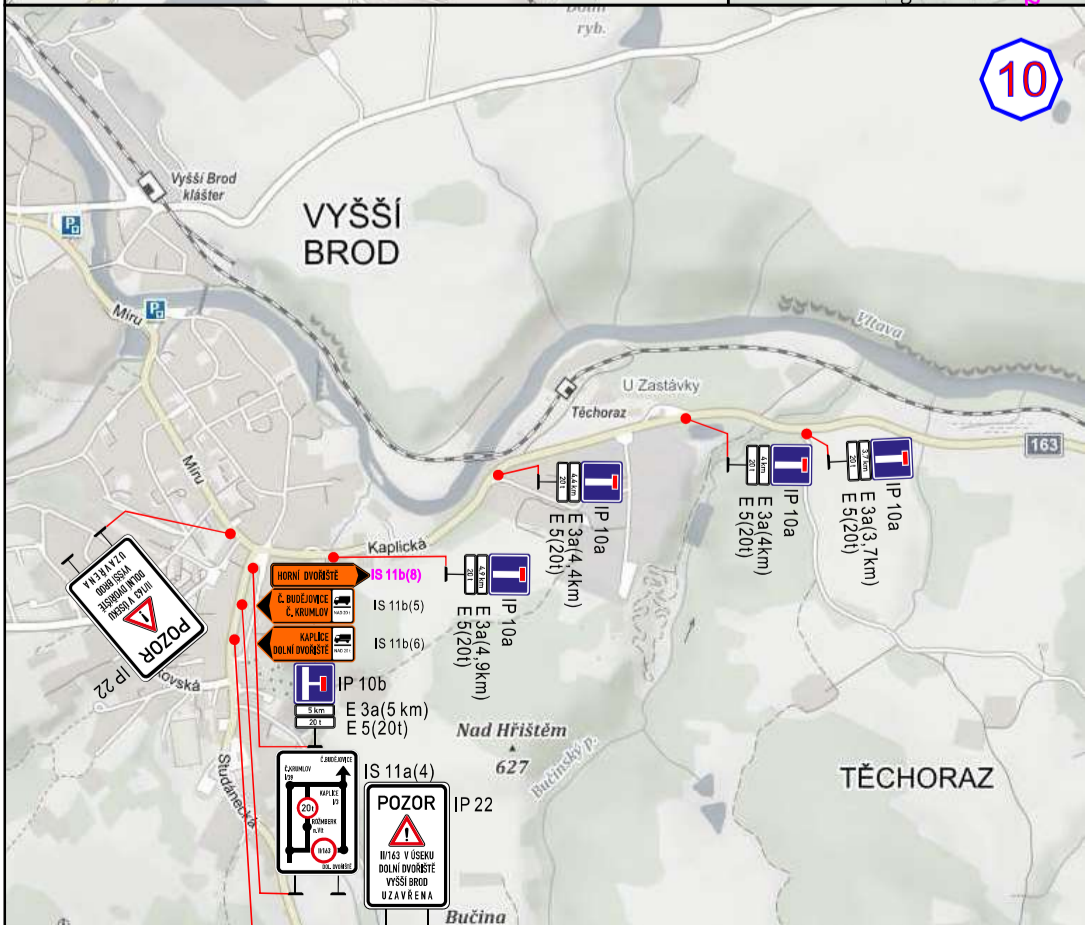
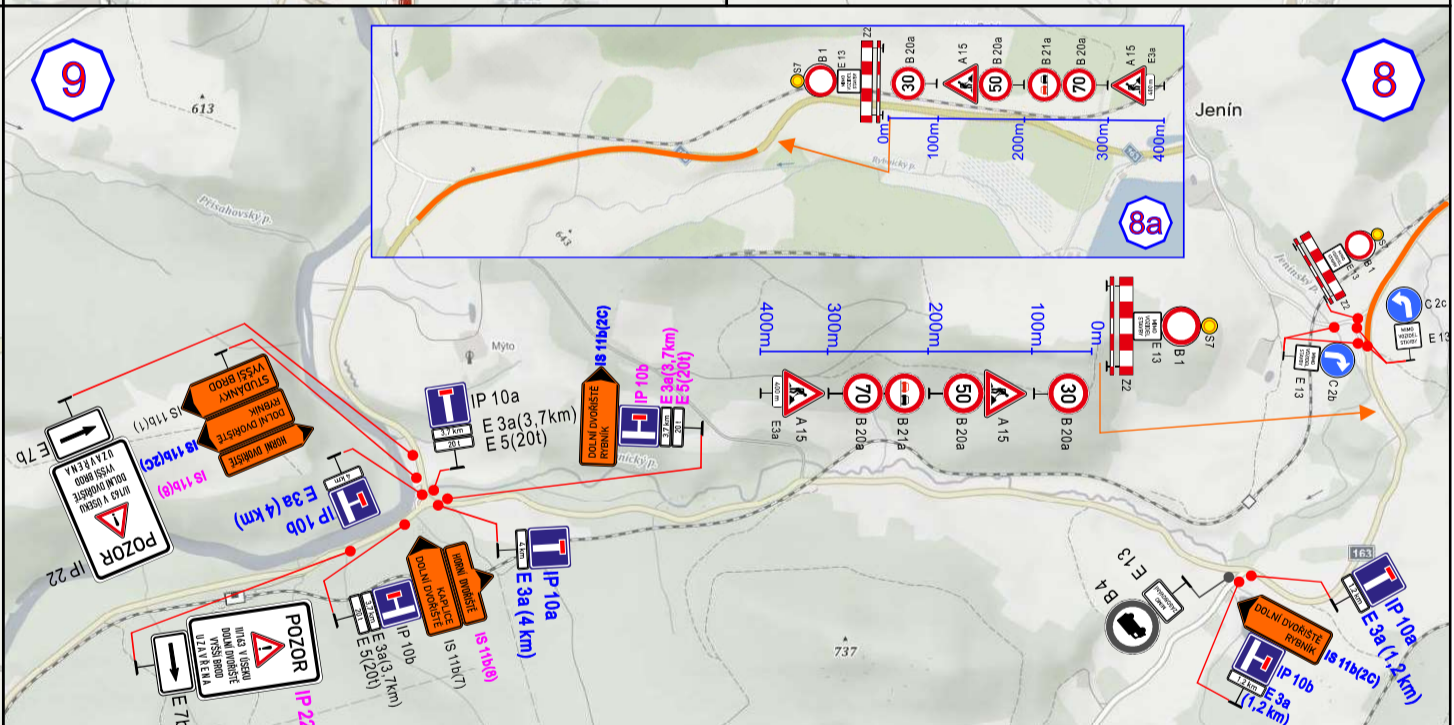
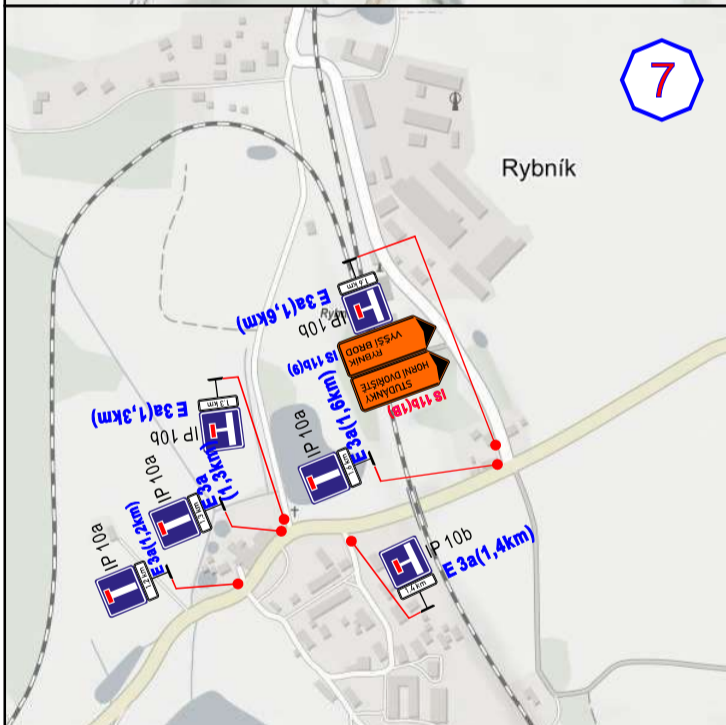
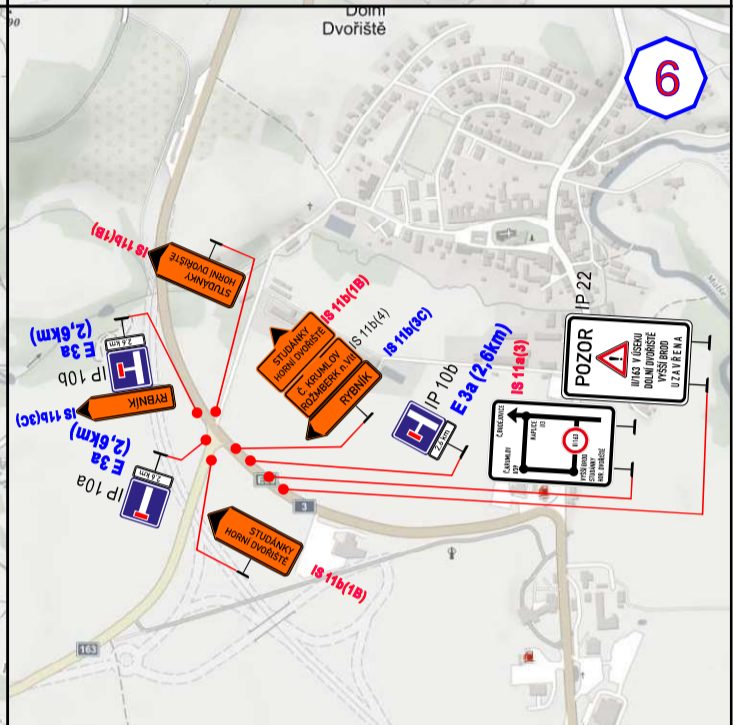
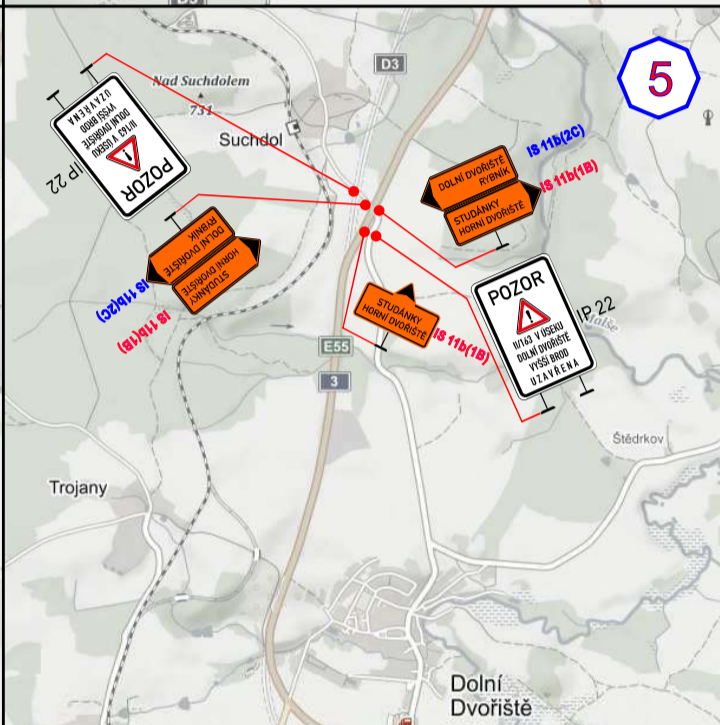
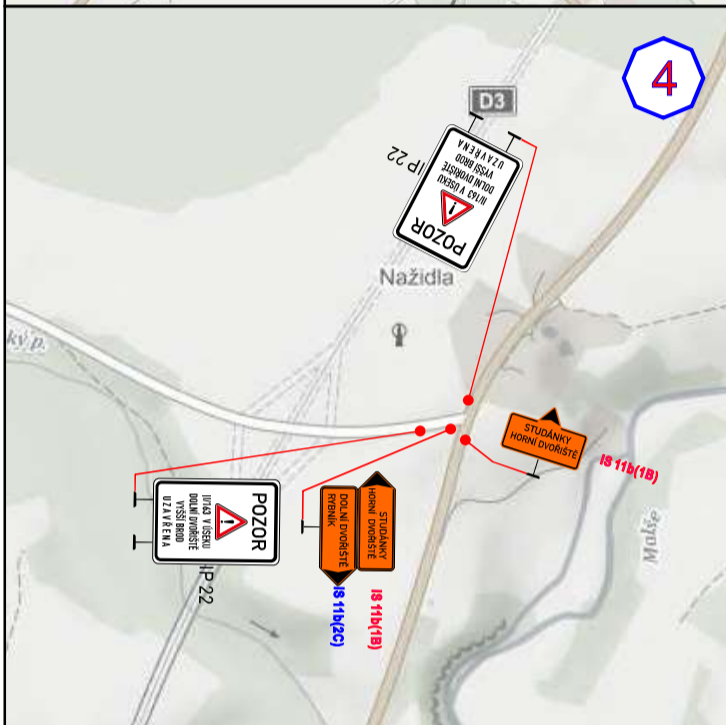
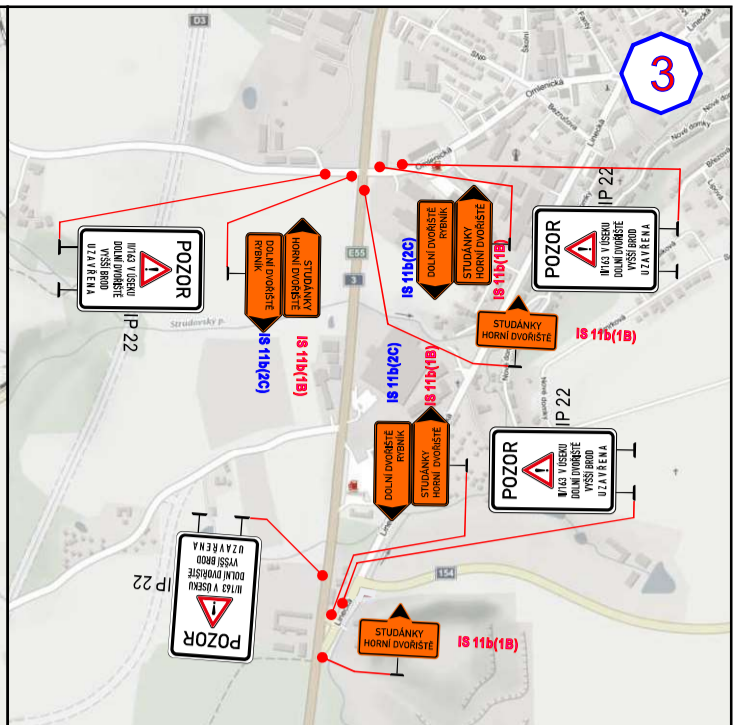
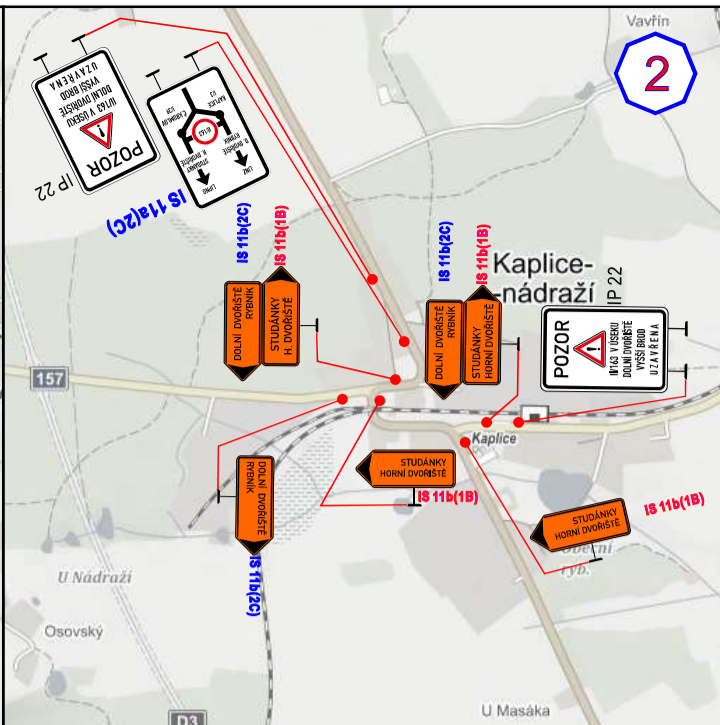
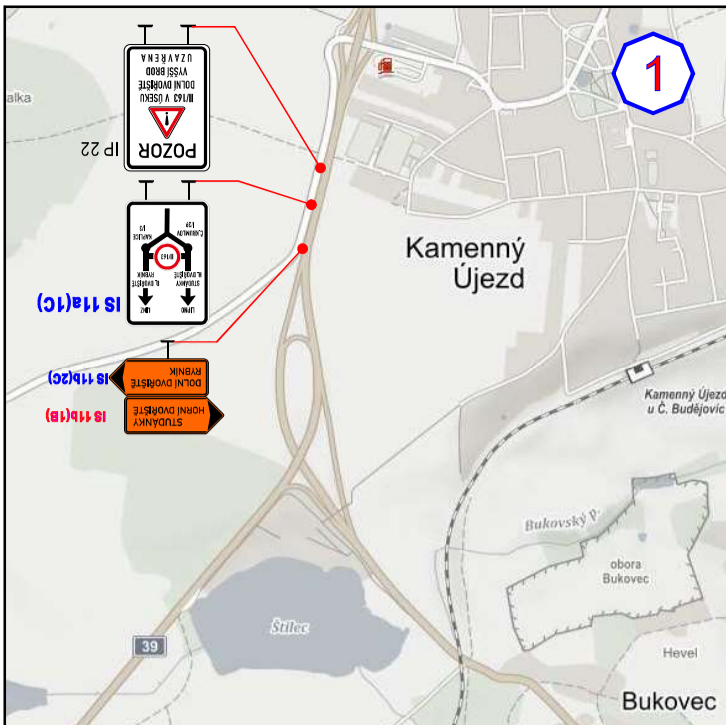

3. etapa - odbočka Jenín - KÚ (635m)

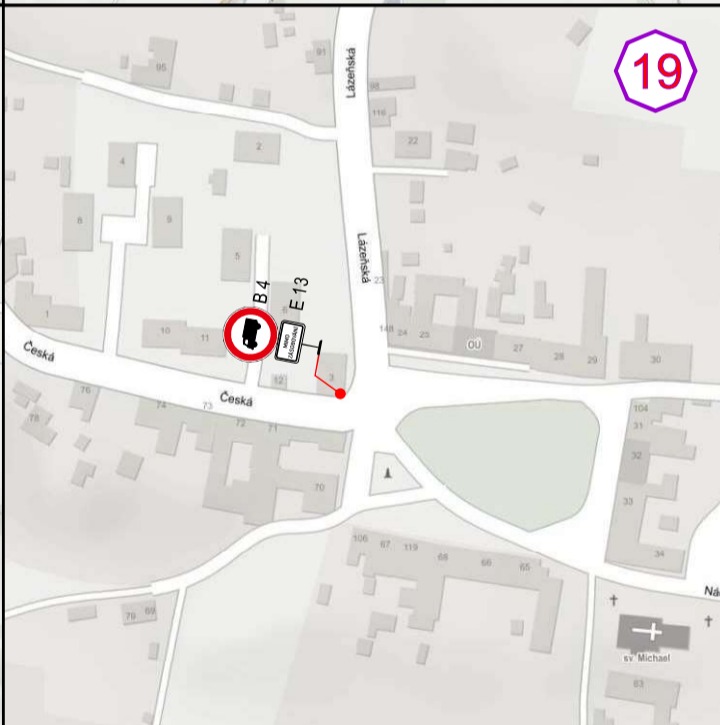
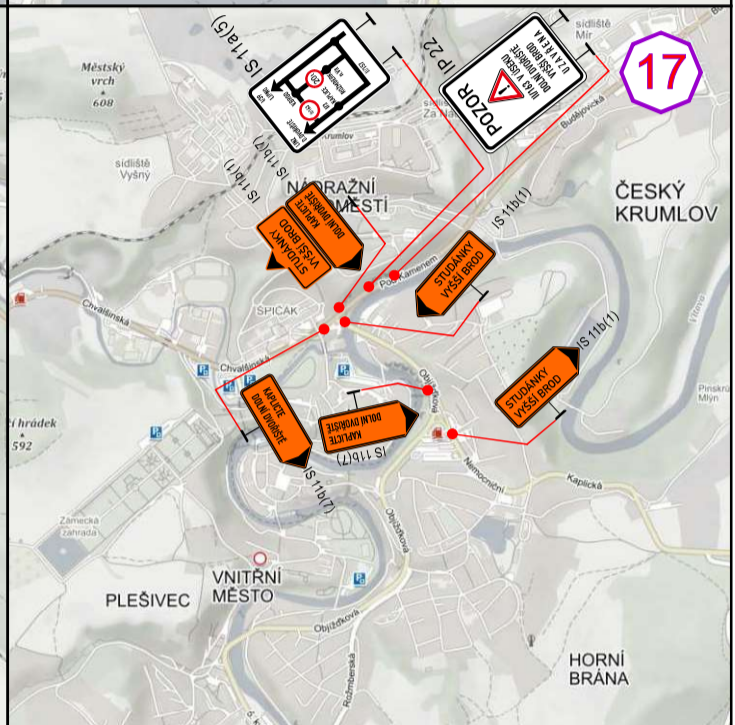
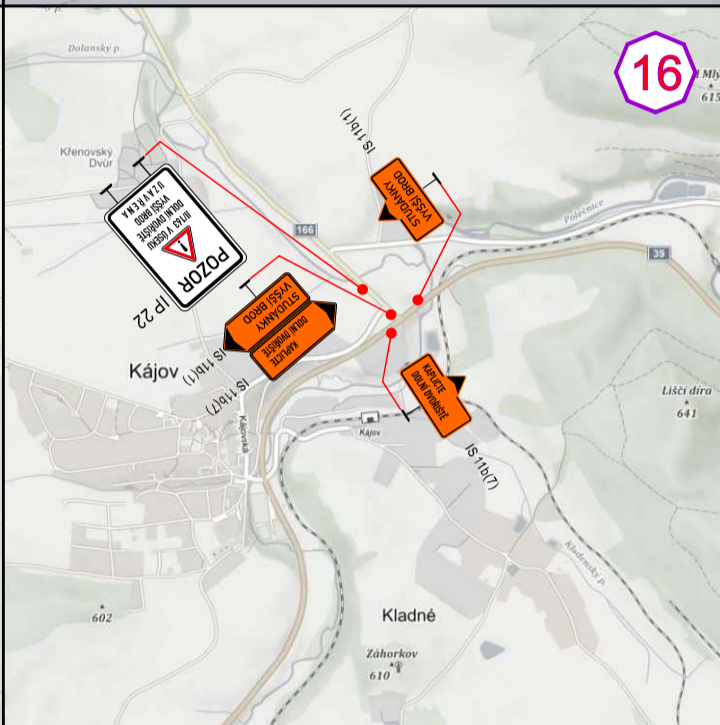
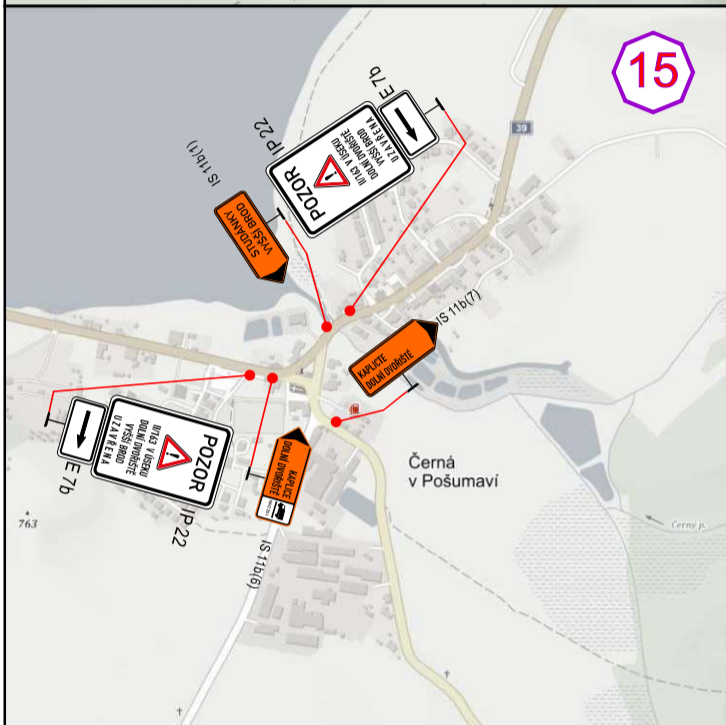
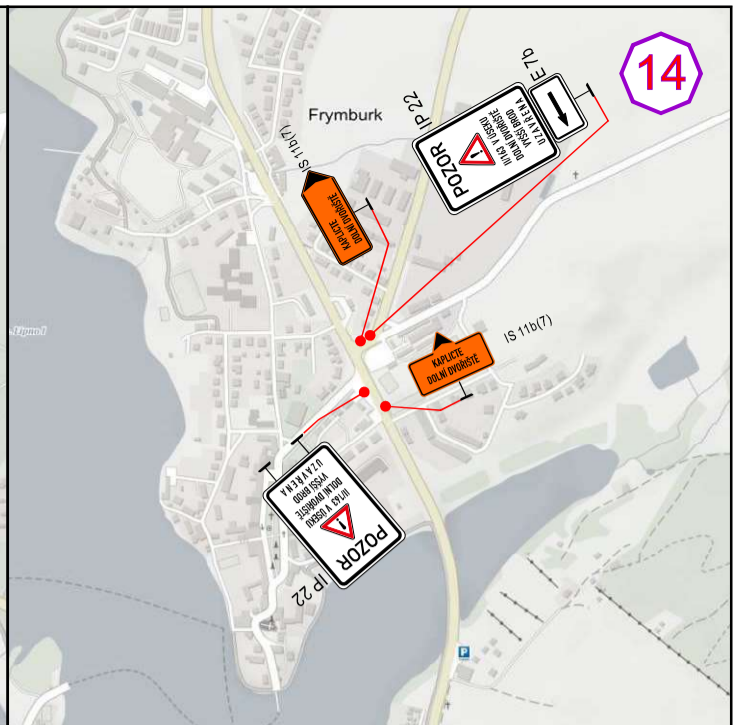
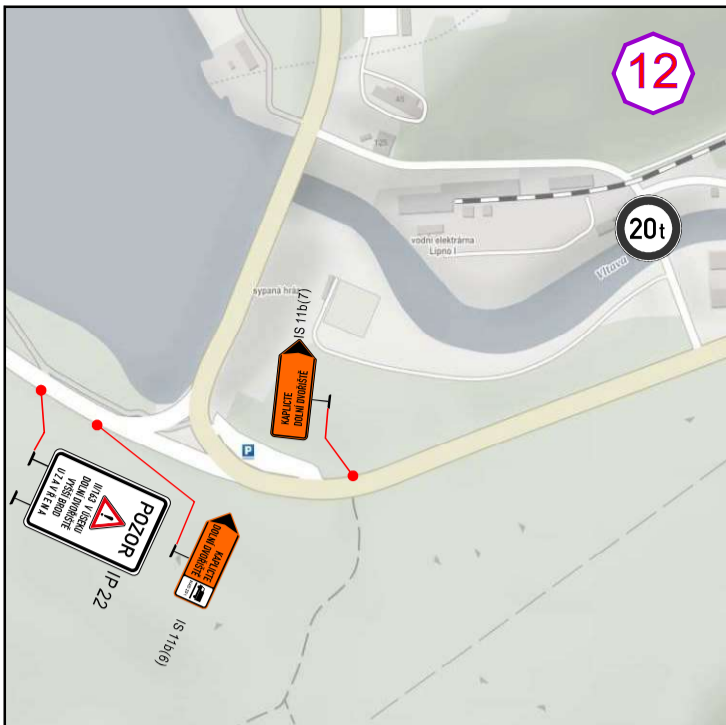

- STUDÁNKY  
HORNÍ DVOŘIŠTĚ IS 11b(1B)
- DOLNÍ DVOŘIŠTĚ  
RYBNÍK IS 11b(2C)
- RYBNÍK  
JENÍN IS 11b(3B)
- Č. KRUMLOV  
ROŽMBERK n.Vlt IS 11b(4)
- Č. BUDĚJOVICE  
Č. KRUMLOV NAD 20t IS 11b(5)
- KAPLICE  
DOLNÍ DVOŘIŠTĚ NAD 20t IS 11b(6)
- KAPLICE  
DOLNÍ DVOŘIŠTĚ IS 11b(7)
- HORNÍ DVOŘIŠTĚ IS 11b(8)
- RYBNÍK IS 11b(3C)
- VYŠŠÍ BROD  
JENÍN IS 11b(9)

